



# **8K Hydraulic Jack Installation and Operation Instructions**



Pacific Rim International, LLC  
19120 SE 34<sup>th</sup> Street., Suite 105  
Vancouver, WA 98683  
Phone: 360-859-3828

*RAM* hydraulic jacks are for trailer applications only. They are designed for maximum support of 8,000lb (per leg) and lift capacity of 8,000lb (per leg).

Always load trailer when attached to the tow vehicle.

Pacific Rim International/Pacific Trailer Products is not responsible for damages as a result of improper use, installation and care for product.

Maximum pump load to not exceed 3200 psi.

Direct weld applications follow ASTM for welding to carbon and low alloy steel tubes. Weld per specific application. Weld however should not be closer than 1" from the top of the outer tube nor 1" from the bottom of the outer tube.

## General Information

Up body hose is attached to extend port “raising/extending” of hydraulic jack.

Down body hose is attached to retract port “lowering/retracting” of hydraulic jack

If two jacks being used (in tandem) then the flow divider is strongly recommended between the HPU unit and the jacks

When using with a dump trailer hoist system a diverter valve should be used.

Hoses, flow dividers, HPU’s, etc are available and sold separately.

Several complete suggested hydraulic circuits follow below.

## Hydraulic Jack Ports

9/16-18 #6 SAE JIC 37 degree flare fitting retract port

9/16-18 #6 SAE JIC 37 degree flare fitting extend port

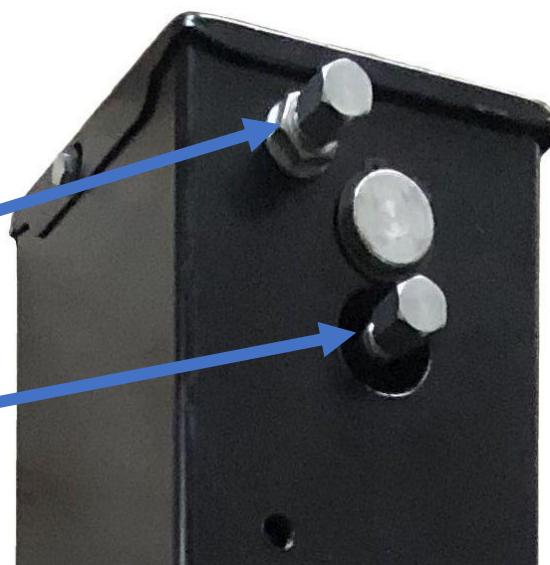

# Single Hydraulic Jack Application

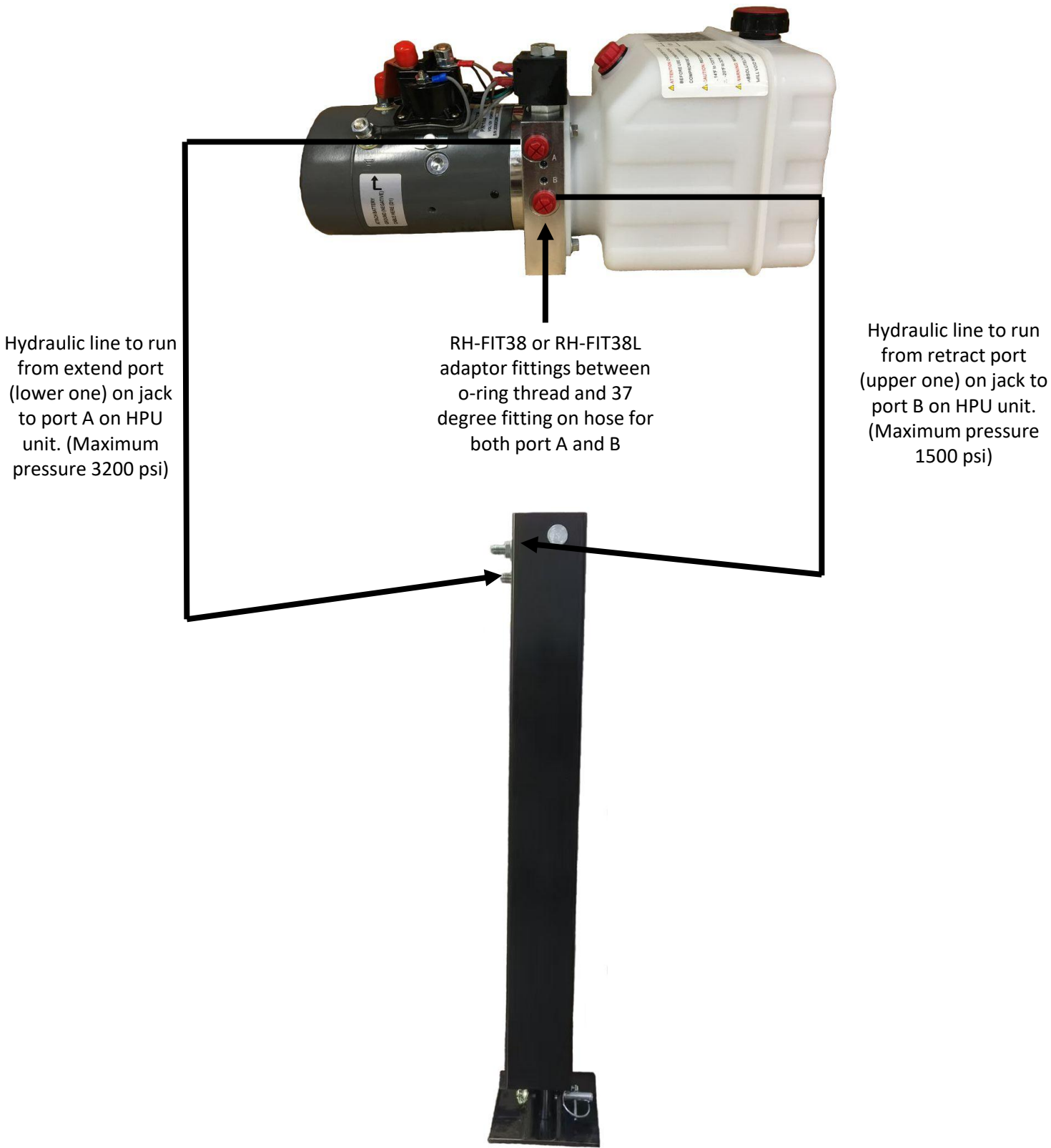

# Dual Hydraulic Jack Application

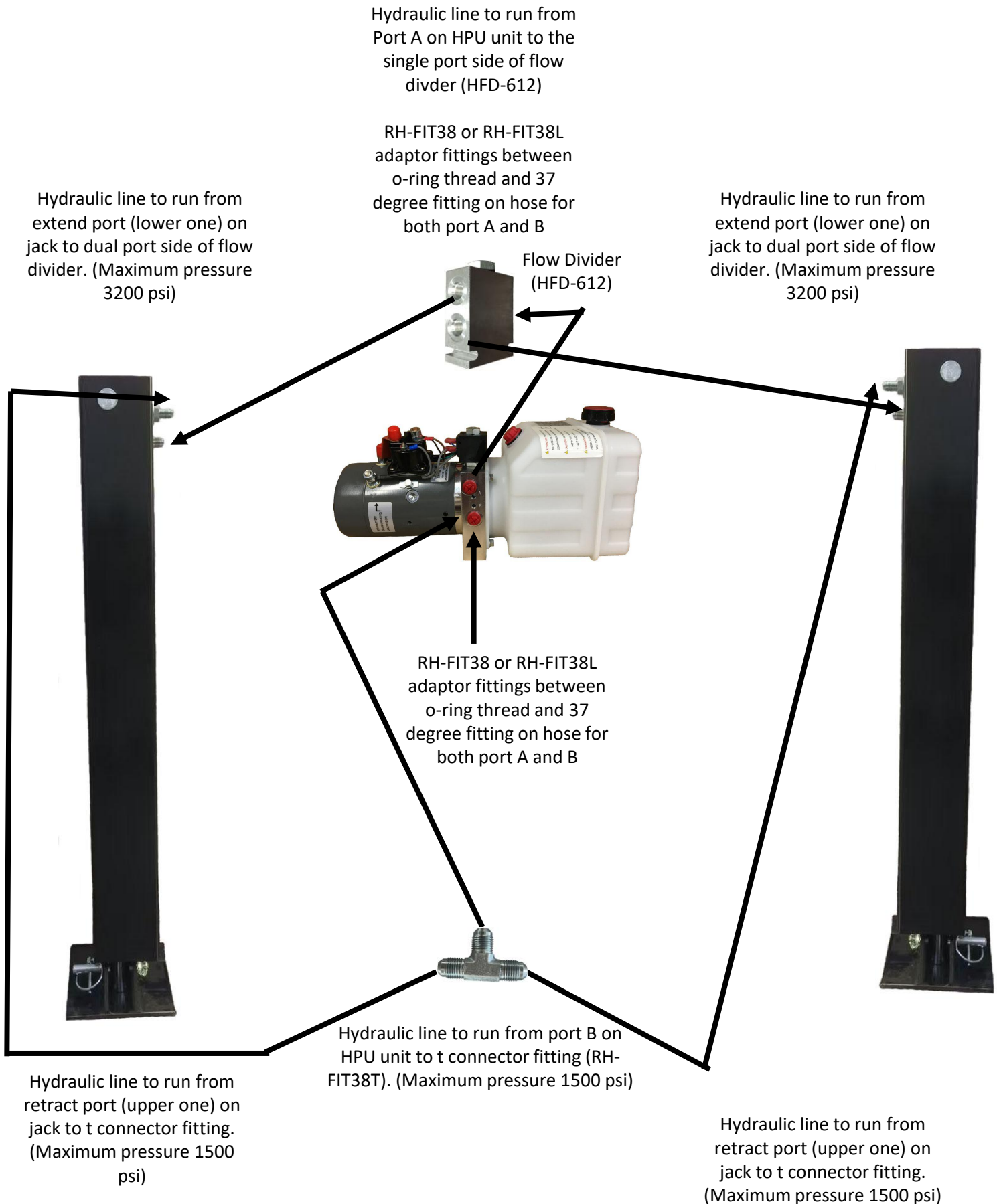

# Dual Hydraulic Jack and Hoist Cylinder Application

RH-FIT38 or RH-FIT38L  
adaptor fittings between  
o-ring thread and 37  
degree fitting on hose for  
all ports

**In this application, use a six  
quart reservoir or greater.**

Hydraulic line to run from port  
A on HPU unit to port P of  
hydraulic diverter (RH-6WFD).  
(Maximum pressure 3200 psi)

Hydraulic line to run from port  
B on HPU unit to port T of  
hydraulic diverter (RH-6WFD).  
(Maximum pressure 1500 psi)

Flow Divider  
(HFD-612)

Hydraulic Diverter  
(RH-6WFD)

Hydraulic cylinder on hoist

T Connect (RH-  
FIT38T)

**Between hose and cylinder at  
this point use load control valve  
(RH-LDCTL)**

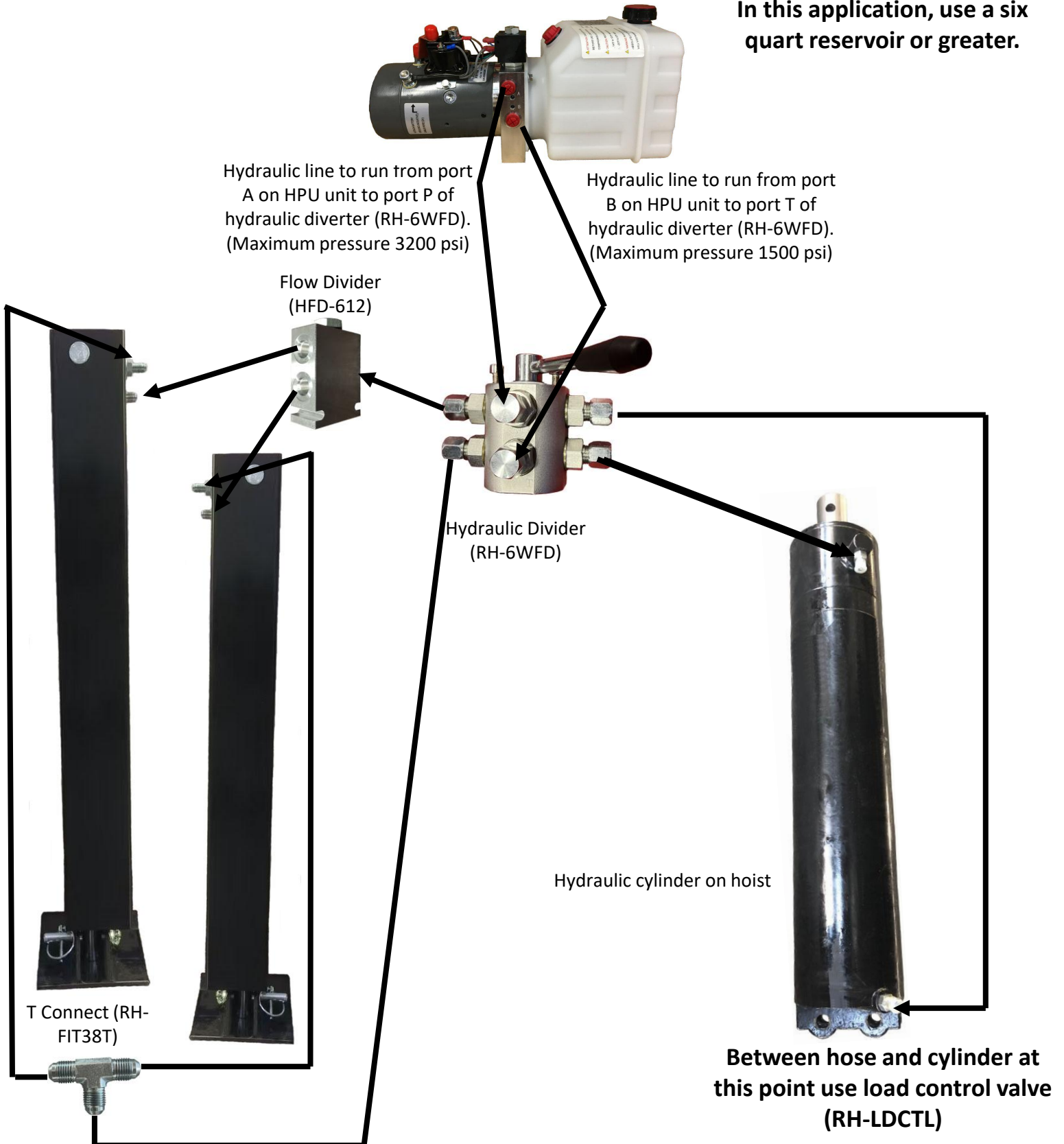

## **8K Hydraulic Jack Operation and Maintenance**

Before operating hydraulic jack, make sure trailer is on a flat/even surface. Make sure that surface is capable of holding the weight of the trailer.

When using jack for the first time, you will need to bleed the hydraulic jack and hoses of any air in the system. Following the bleeding instructions in the (HPU) Hydraulic Power Unit manual.

Do not lubricate tubes on jacks. Lubricant can attract dirt which could affect operation of jack.

### **Troubleshooting**

If jack is not extending or retracting check the following:

- Make sure all electrical connections are secure and battery is fully charged and grounded.
- Make sure hydraulic fluid is flowing from the HPU unit and through the lines. Check to make sure there are no leaks or pinch points in the hoses and all hydraulic connections are secure.
- If jack retracts after leveled to desired location, check fluid level in the HPU unit and that all hydraulic connections are secure.
- Can also refer to Q&A section on our website.  
[www.ramtrailerproducts.com](http://www.ramtrailerproducts.com)